



HSV⊕ Filter Housing

- industrial vent

- Industrial vent housings
- Available in ATEX version
- Beverage, pharmaceutical and industrial surface finishes available
- Available in various connection types



Specification

Materials of Construction

- Housing: 316L Stainless Steel
- Seals: EPDM FDA
PTFE FDA
Silicone FDA
Viton FDA

Note: Seal used only to position bowl clamp arrangement.

Surface Finish

- Industrial Finish
 - Internal: As Welded
Pickled & Passivated
 - External: Polished 0.8 µm Ra
- Beverage Finish
 - Internal: Polished 0.4 µm Ra
 - External: Polished 0.25 µm Ra
- Pharmaceutical Finish
 - Internal: Polished 0.4 µm Ra and Electropolished
 - External: Polished 0.25 µm Ra

Welding

All assembly welds are full penetration. All welds are crevice and undercut free.

Weld finish & detail drawings available upon request.

Design Basis

ATEX 94/9/EC *(where applicable)*

Working Condition PED 97/23/EC			Volume (litres)				
Variant	State	Temperature	01K	011	012	013	014
Standard	Gas / Vapour	150 °C [302 °F]	1.6	2.8	4.7	6.6	8.5
ATEX	Gas / Vapour	135 °C [275 °F]	1.6	2.8	4.7	6.6	8.5

Physical Characteristics

Bowl Height	Dimensions (mm)	Dimensions (mm)			Typical Weight (Kg)		
		'A'	'B'	'C'	Bowl	Head	Total
5" (125 mm)	132 274 194	132	274	194	0.9	2.6	4.0
10" (250 mm)	132 424 313	132	424	313	1.5	2.6	4.6
20" (500 mm)	132 674 561	132	674	561	2.5	2.6	5.6
30" (750 mm)	132 919 809	132	919	809	3.5	2.6	6.6
40" (1000 mm)	132 1169 1057	132	1169	1057	4.5	2.6	7.6

Dimensions shown are for a vessel with 1 1/2" BS4504 DIN 2633 outlet port. For other formats, please contact Parker dominick hunter.

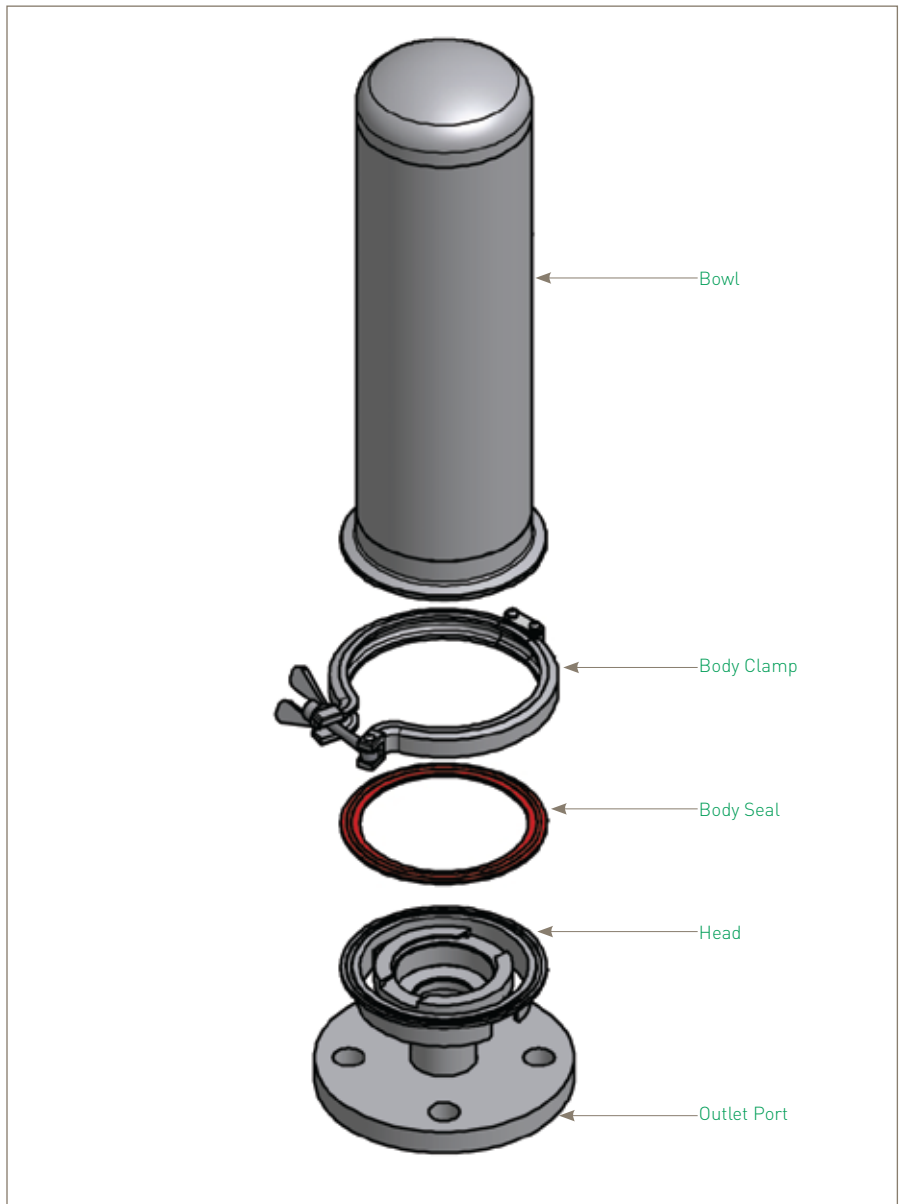
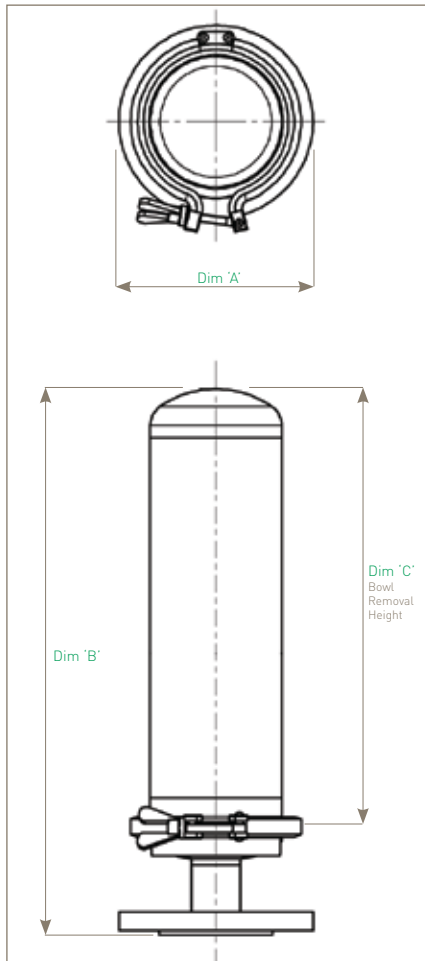

Ordering Information

HSV	<input type="checkbox"/>	01	<input type="checkbox"/>	<input type="checkbox"/>	<input type="checkbox"/>	<input type="checkbox"/>	<input type="checkbox"/>	-	<input type="checkbox"/>	-	<input type="checkbox"/>
Code Vessel Class	Code Length (Nominal)	Code Connection Size	Code Standard	Code Cartridge	Code Seal	Code Surface Finish	Internal	External	Code Tagged		
DH Standard AT ATEX	K 5" (125 mm) 1 10" (250 mm) 2 20" (500 mm) 3 30" (750 mm) 4 40" (1000 mm)	C 2" (50.8 mm) Y 1 1/2" (38.1 mm)	B BSPP (F) D DIN11851(M) F ANSI RF150 L BS4504 DIN2633 N NPT (F) T Tri-Clamp W BS / ISO Pipe	C 226	E EPDM P PTFE S Silicone V Viton	B Beverage I Industrial P Pharmaceutical	0.4 µm As Welded 0.4 µm EP	0.25 µm 0.8 µm 0.25 µm	T Yes X No		

For Tagged Options customer identification numbers required at time of ordering

Parker dominick hunter has a continuous policy of product development and although the Company reserves the right to change specifications, it attempts to keep customers informed of any alterations. This publication is for general information only and customers are requested to contact our Process Filtration Sales Department for detailed information and advice on a products suitability for specific applications. All products are sold subject to the company's Standard conditions of sale.